



**Bornemann
Pumps**



**Sanitary line
Industrial line**

General catalog

Bornemann Pumps

Sanitary and industrial progressive cavity pumps



Main features of our pumps:

- Excellent volumetric and mechanic yielding due to the “*State of the Art*” technology developed together with our headquarters in Germany
- Optimized energy consumption that enables a cost reduction and an increase in the profitability of the equipment and the sector
- 12 months of written warranty
- Exclusive after-sales service in all the country
- We count with all the spare parts for an immediate delivery
- National manufacturing in our plant in Buenos Aires
- They pump all kinds of low or high, neutral or aggressive viscosity liquids. Liquids containing fibres or solids, gas or foam media
- They are self-priming and of continue operation. Easy to handle and maintain. Without pulsations and free from turbulence

Some technical details:

- **Pressure Flange.** Normalized, for different stages of pressure and suitable materials
- **Cardan Joint.** Hermetically armored against liquids, resistant to all the turning and strength moments during continuous work
- **Shaft seals.** Easy to change or replace by other kinds of seals
- **Drive Shaft.** Made in resistant material, good sized and placed in strong bearing housing
- **Stator.** Made from special custom made elastomers, vulcanized in a steel tube
- **Helical Rotor.** Made of special steel with fine polished surface
- **Pump housing.** Made of varied construction shapes and from different materials

Range

1 stage:	up to 6 bar
2 stages:	up to 12 bar
4 stages:	up to 24 bar
EP Pumps:	up to 80 bar

Capacity

0 - > 250 m³/h

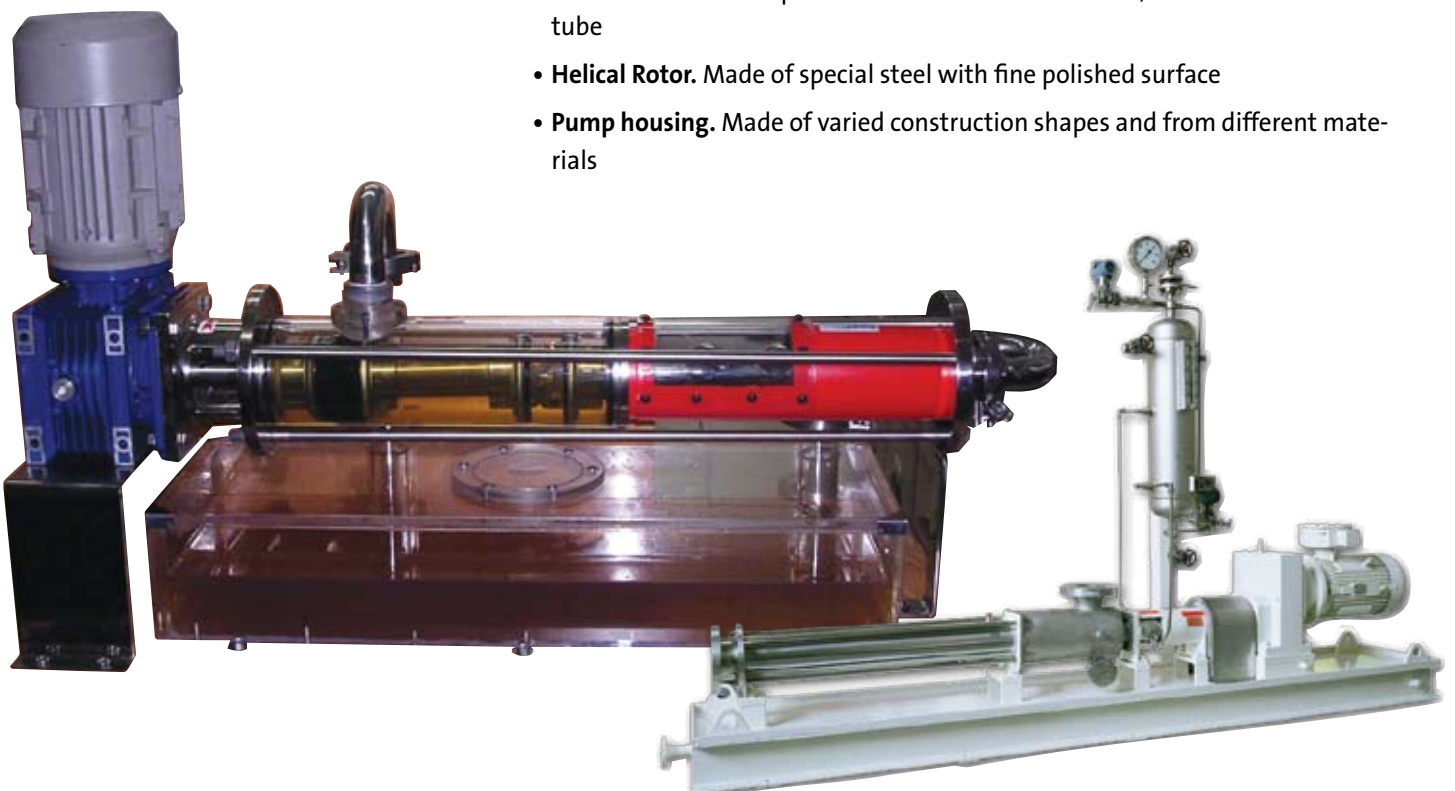

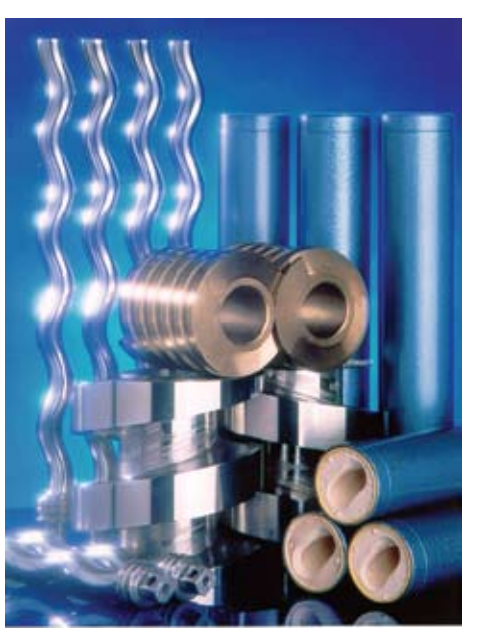
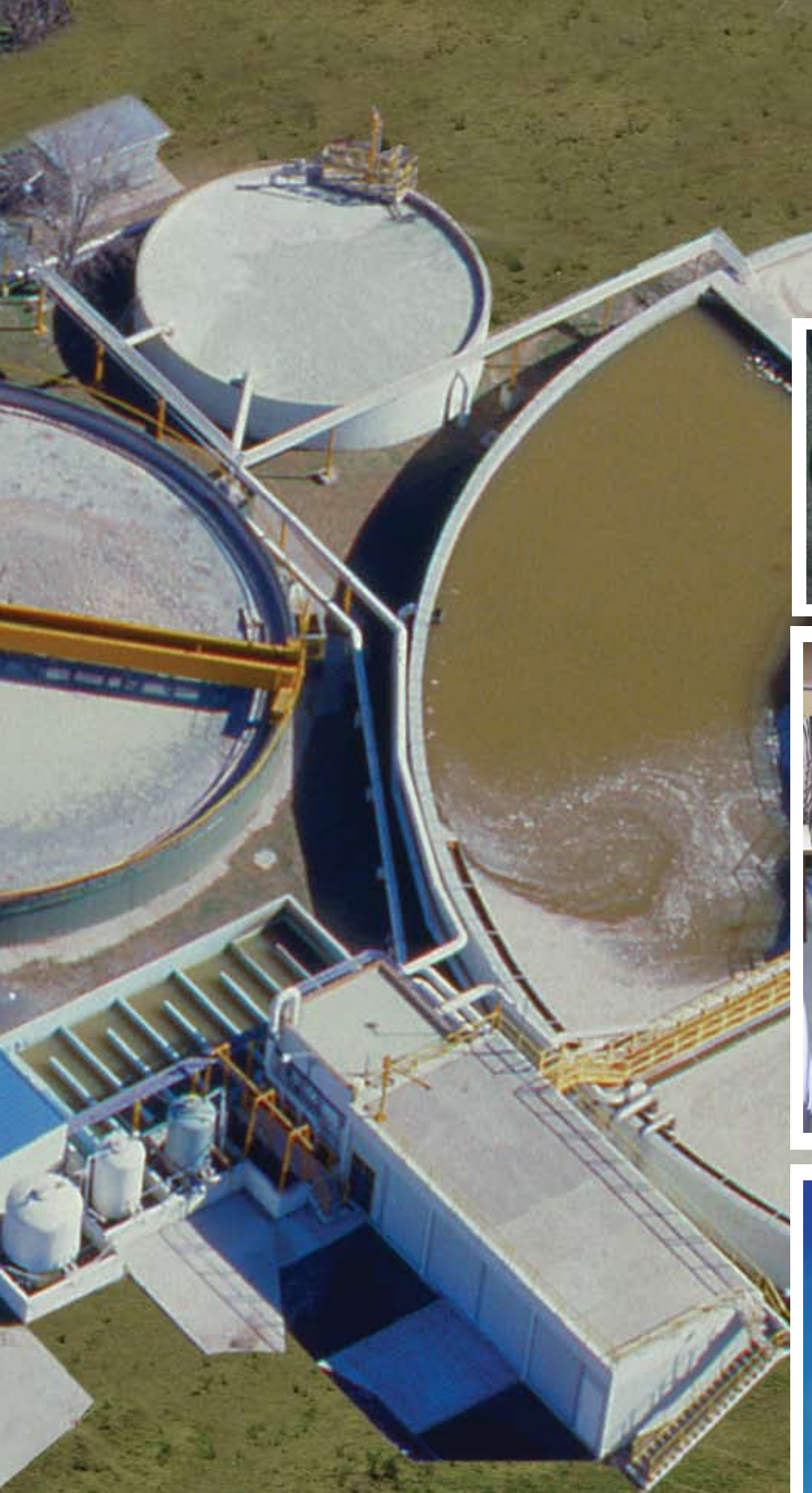

Eccentric screw pump Bornemann Pumps

Pumps are self priming, rotative. They have no valve and their construction is simple

Characteristics:

- Pumps are distinguished for the ability to provide a **high vacuum in the suction pipe**, thanks to the seal lines together with the combination of the elastomer for the stator and the metal for the rotor, which means that they are self priming. This feature is maintained even with gas-liquid mixtures. The entrance and exit openings of the transversal section of the compartment are always the same. This is the reason why there is a continued capacity, without pulsations.
- **Compartment outline.** In this figure it can be noticed that the eccentric screw Bornemann Pumps are able to pump liquids with a great amount of fibers without any difficulty
- The gentle treatment received by the fluid can be observed in the pumping of yoghurt with whole fruit. They remain with the same look, size and surface
- Pump elements at 0°, 90° y 180°

Pump drawing

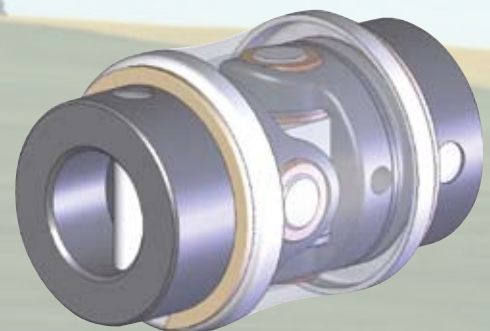
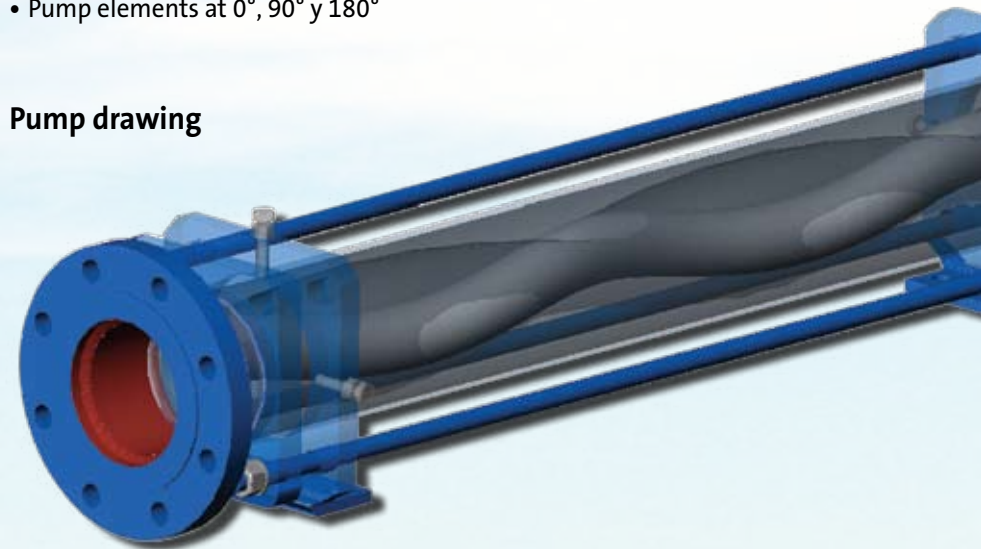

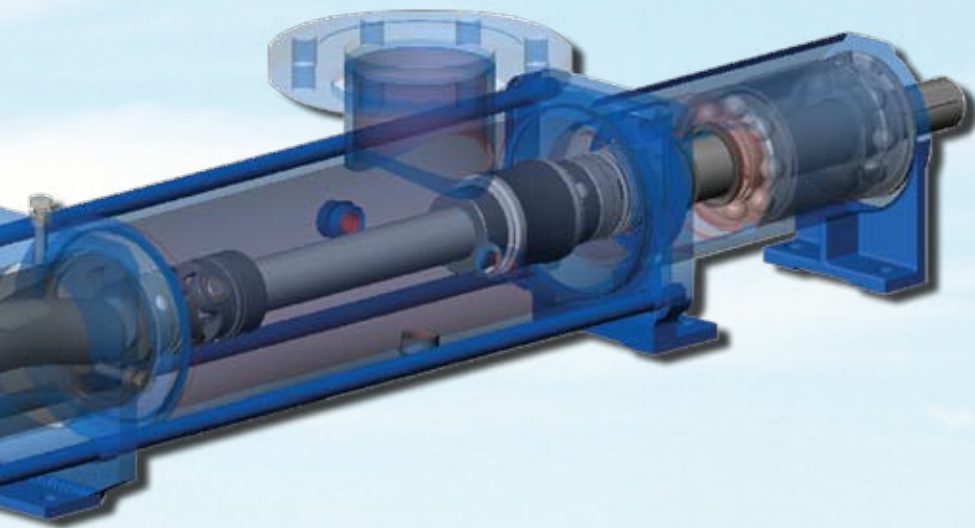
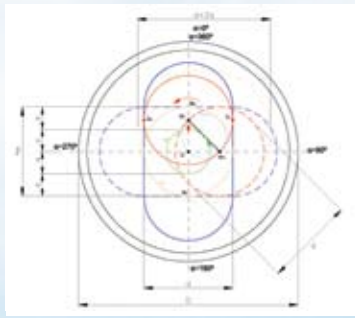
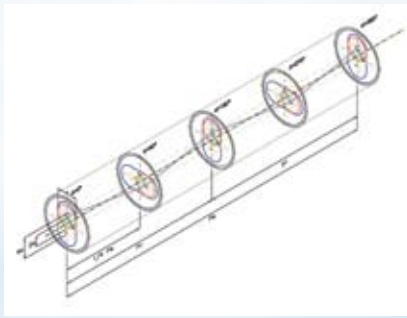

Application range chart

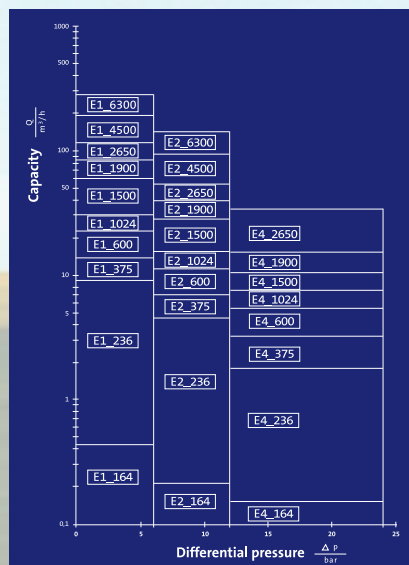

Sanitary line Bornemann Pumps

ET model:

- Pump for emptying containers, easy to handle. Built in stainless steel



EDRS model:

- Sanitary pump with hopper and screw feeder for grinding, fish, meat, suspended solids



EDS / ES model:

- Economic direct drive pump for sanitary applications
- Sanitary Pump. Basic version with bearing housing. Multiple pump options. Pharmaceutical, Cosmetic and Food industries



Micron model:

- Pump for high accuracy dosing for small amounts of fluid



EFS model:

- Ultra-sanitary pump. With flexi-shaft. Certified 3-A. With an additional CIP fitting. Extreme sanitary and asepsis requiring Industry

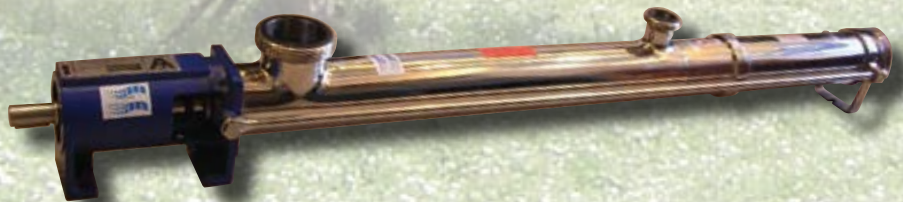

Industrial line Bornemann Pumps

ER model:

- Industrial pump, with hopper and screw feeder, for extreme viscosity fluids or of difficult loading



EU model:

- Vertical Pump, pumping elements immersed in fluid



EH model:

- Basic pump, industrial version, with bearing housing. Multiple versions



EP model:

- Pump for pressures up to 80 Bar



EL model:

- Basic pump, industrial version, compact. Easy to assemble with small dimensions. Normalized. Multiple versions



Tools:

- One of the characteristics of Bornemann pumps is that their installation and maintenance is easy to achieve, that's the reason why the necessary kit has only 7 pieces for a correct execution



Joh. Heinr. Bornemann was founded in 1853; the company is a world leader in the design and manufacturing of progressive cavity pumps with more than 95 points of assistance worldwide. Since 1983, **Argentina Bornemann Pumps** produce pumps in this country with the quality and technology of the Joh. Heinr Bornemann German group. Simple progressive cavity pumps for the pumping of all kinds of fluid. They are mainly used for soft pumping of fluids: cream, cheese, fine wine, air or gas solved fluids, heterogeneous fluids without producing any emulsion. Pumping of fluids with particles: yoghurt with fruit, must, liquid distilled from grapes or herb pressings, wine must, preserves, mud with sand, pulp, fluids with fibers. Pumping of fluids which are difficult to suck: extraction of distillers, evaporators and bunchers' bottoms. Pumps for oil industry: separation station and plant, API pool and ground pool, recirculation, portable equipment, sediment and mud extraction, water formation and re-injection. Multiphase Pumps (water, oil and gas simultaneously).

Besides, **Bornemann Pumps** Pumps count with a complete after sales service with a wide and professional world-wide representatives network. We are able to provide and administrate CAD systems and ready to use process engineering.

Bornemann Pumps have certified in ISO 9001 and have ultra-sanitary 3A approved models. Besides, they have certified ISO 14001 standards. It is additionally the representative and authorized service of the German companies:

Philipp Hilge

Highly sanitary Centrifugal Pumps

Bran + Luebbe

Pumps and dosing systems

Aerzen

Compressors and blowers

Jabsco

Lobe and flexible rotor pumps

Kral

Three spindle progressive cavity pumps

Krytem

Pumps and cryogenic systems

Pumps and systems engineering for food, ecological, oil and naval industry

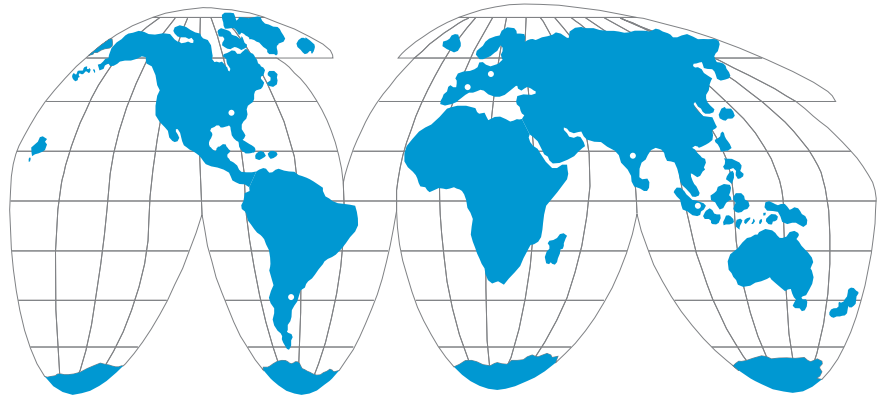

Distributor

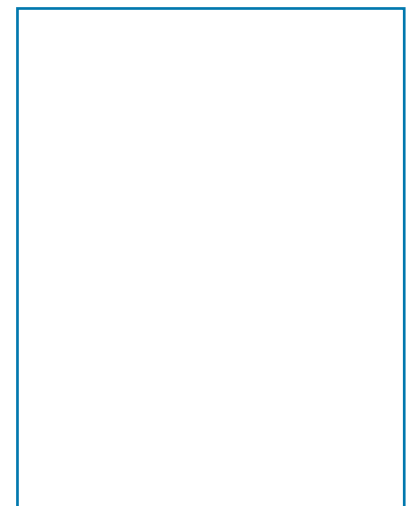

Argentina

Bombas Bornemann S.R.L.

Part of the J.H. Bornemann GmbH Group - Germany

Armenia 2898 - B1605CDP Munro - Bs.As. - Argentina

Tel.: +5411 4756-8008 Fax: +5411 4756-5541

E-mail: info.ar@bornemann.com - www.bornemann-ar.com